

New Kings Road, SW6

Approximate Gross Internal Area
32.81 sq m / 353 sq ft

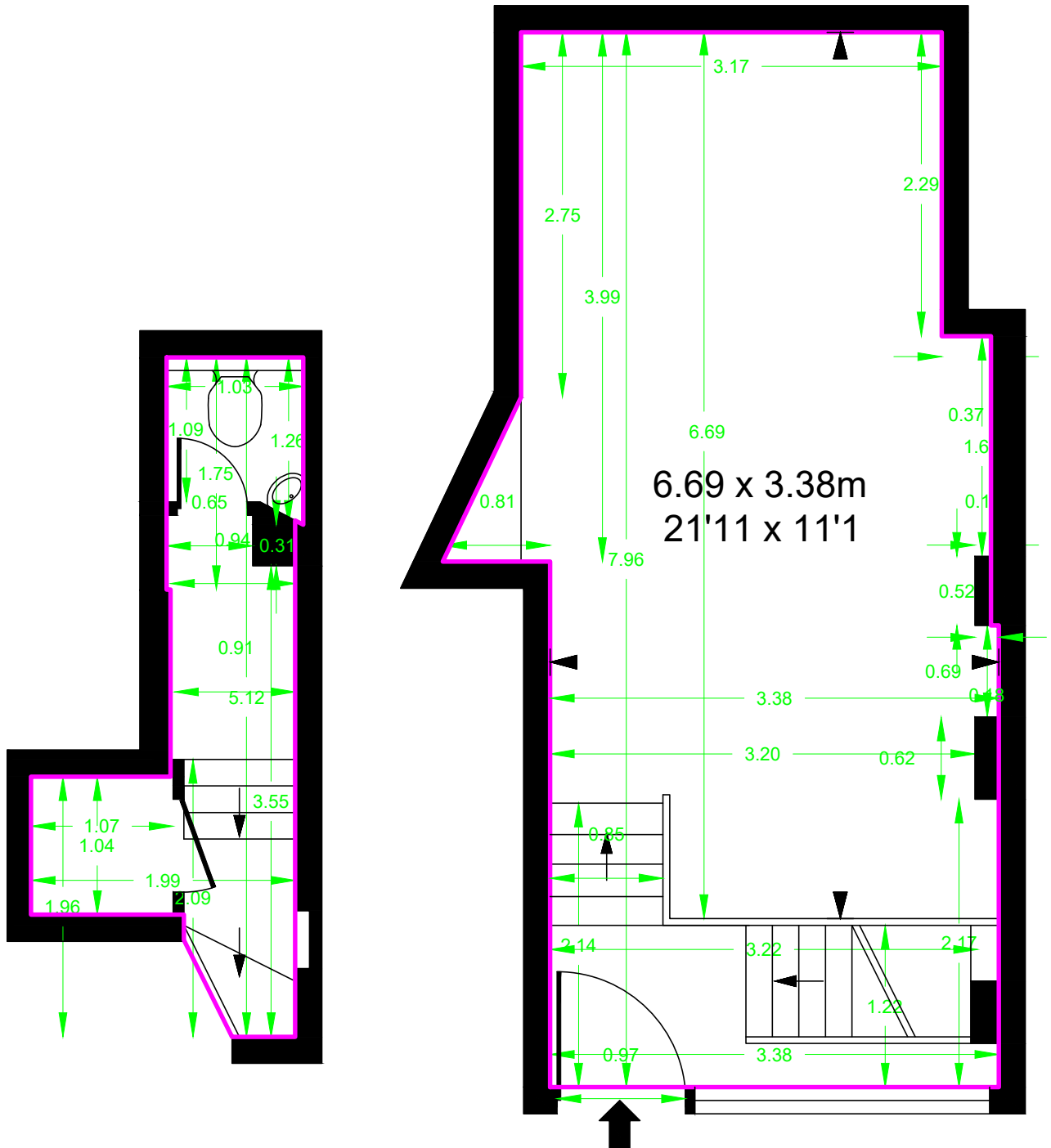

Basement
Approximate Gross Internal Area
5.81 sq m / 63 sq ft

Ground Floor
Approximate Gross Internal Area
27.00 sq m / 291 sq ft

This plan is not to scale. It is for guidance and not for valuation purposes.
All measurements and areas are approximate only, and have been prepared in accordance with the current edition of the RICS Code of Measuring Practice.
© Fulham Performance